

Cardboard Shredder Machine

Operation Manual

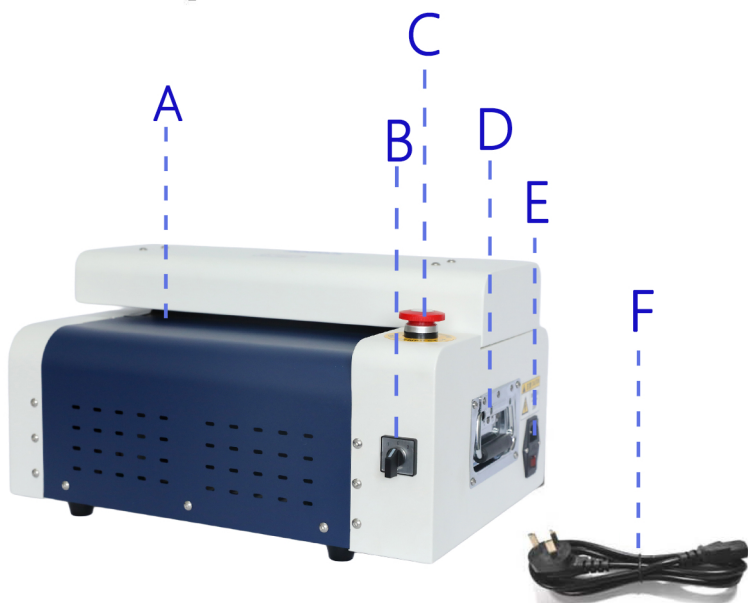

A:Paper feeder

B:Reversible switch

C:Emergency stop switch

D:Handle

E:Power switch socket

F:Power cord

1.Notice

Please read it carefully before use:

1. 1 Take the machine out of the carton carefully
1. 2 Place the cardboard shredder machine on a clean table



2.Operation Manual

2.1 Connect the power supply and connect the power cord to the socket.

2.2 Preparation before use

2.2.1 Before the machine starts to work, check whether the scraps of paper collection drawer is closed. If it is not closed, the machine cannot be started.



Make sure that the scraps of paper collection drawer is closed.

2.2.2 Before turning on the power switch and operating the machine make sure you understand the function of each button (as shown below).

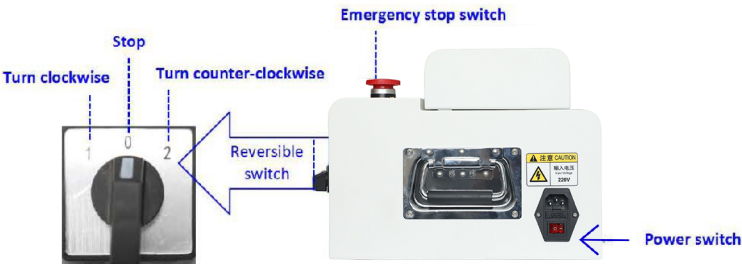

2.3 How to Use

2.3.1 Turn on the power switch and turn the reversible switch to “1”.



2.3.2 Nails and other metal objects entering the machine will damage the machine. Before placing the corrugated paper, check whether there are metal objects on the corrugated paper. After confirming that there are no metal objects, place the corrugated paper parallel into the paper inlet, and the machine will start to make buffer materials.

(Turn clockwise, turn counterclockwise and stop, these three functions need to pause 1-2 seconds when switching.)

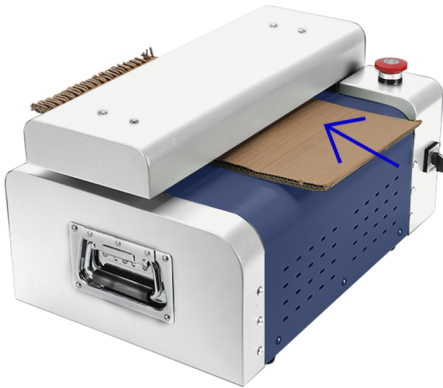

Place the corrugated paper parallel to the machine.

2.3.3 After the cardboard cushioning material is made, turn the switch to "0" and the machine will stop immediately.

2.3.4 If the paper is jammed in the machine or needs to be withdrawn, then turn to "2" and pull the paper out by hand at the same time.

2.3.5 Please be sure to stop the machine before turning off the power switch.

3. Electric Safety

3.1 Make sure the machine is connected to the appropriate voltage.

3.2 The use of the power extension cord must match the rated power of the machine.

3.3 Ensure that the AC power supply is securely grounded.

3.4 If the power cord is damaged, do not operate the machine.

3.5 The machine must be repaired by professionals.

4. Machine maintenance

4.1 Please unplug the power cord from the machine during maintenance and cleaning.

4.2 Ensure that there are no waste paper scraps or other dirt at the paper inlet and exit.

4.3 Regularly clean the dust at the heat sink of the front cover of the machine.

4.4 Please make sure the inlet for discarded paper scraps, if so, it needs to be cleaned.

5. Parameters

Speed	3m/min
Paper thickness	Less than 7mm
Paper Width	There is no limit to the width of paper, and the width of cardboard that can be cut is 320mm.
Voltage	110V/220V 50/60HZ (selectable)
Power	250W
Machine size	450mmx300mmx270mm
Net weight	29KG